

## Safety information for table saw

This page contains important safety information for those who handle table saws. Please read this information carefully and use the table saws in a safe manner.

### READ AND UNDERSTAND THE INSTRUCTION MANUAL



Improper and unsafe use of a table saw may result in serious injury. Please read the instruction manual enclosed with the product thoroughly before using any table saw.

For a downloadable pdf version of an owner's manual, please visit the product detail page, click on the link for Owner's Manual.

### PRIOR TO OPERATION



**Use safety equipment.**  
**Always wear eye protection.**

Dust mask, non-skid safety shoes, hard hat, or hearing protection must be used for appropriate conditions.



**Loose clothing, jewelry or long hair caught in a moving blade can cause serious injury.**

Do not wear loose clothing or jewelry. Contain long hair.

### BE CAREFUL OF THE POWER



Make sure that the **PLUG IS DISCONNECTED** from the power source when preparing for use or inspecting your tool.

Failure of the above may result in an **UNEXPECTED START OF THE SAW** which can cause serious injury

## BE CAREFUL OF THE POWER

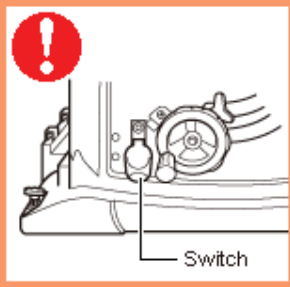

When starting the use of tool, make sure that the **SWITCH IS IN OFF POSITION** BEFORE CONNECTING THE PLUG.

Failure of the above may result in an **UNEXPECTED START OF THE SAW** which can cause serious injury.

## SAFETY RULES FOR TABLE SAW

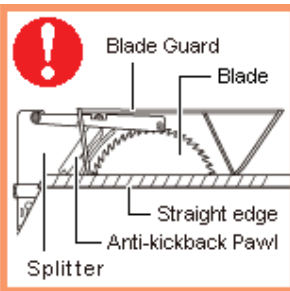

**ALWAYS USE BLADE GUARD, splitter and anti-kickback pawls.**

**WARNING:** Vast majority of the accidents resulting in **finger/hand amputations** occur when the blade guard is removed.

**WARNING:** Lack of splitter and anti-kickback pawls can result in a KICKBACK and **finger/hand amputations.**

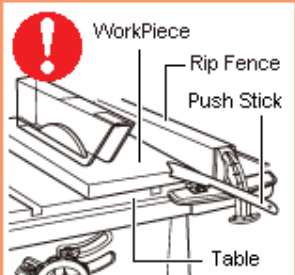
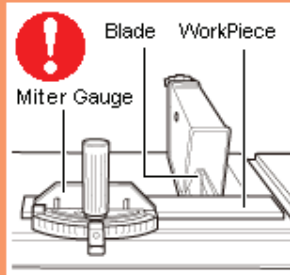

**ALWAYS HOLD WORKPIECE FIRMLY** against the miter gauge or rip fence.

Failure to use the mitre gauge or rip fence is the major cause of kickback and **finger/hand amputations.**

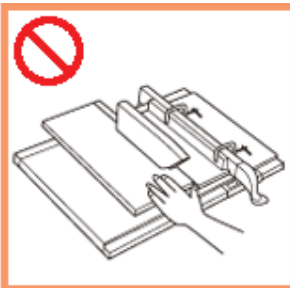

**KEEP HANDS AWAY FROM THE BLADE.**

Hands can dangerously move towards the blade when:

- hands pushing the workpiece are on the line of the cut,
- hands slip as an operator is feeding the stock into the saw,
- hands are placed too close to the blade while cutting, or
- an operator is removing scrap or finished pieces from the table.



Always use a push stick for small pieces of wood and for pushing stock past the blade.

## AVOID ACCIDENTS FROM KICKBACK

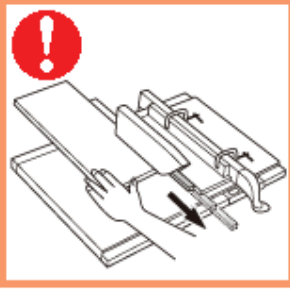

### What is a KICKBACK?

**KICKBACK** is the workpiece thrown towards the operator unexpectedly, caused by a contact of a moving blade and the workpiece.

**KICKBACK** can cause you to lose the control of the workpiece suddenly, which may result in serious injury.

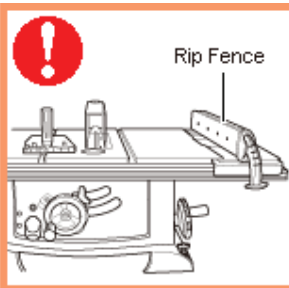

Adjust the alignment of the rip fence accurately.

The method of adjustment is explained in the Instruction Manual. Lack of adjustment may result in KICKBACK and serious injury.



Do not rip workpiece that is twisted, warped or does not have a straightedge to guide it along the fence.



NEVER stand or have any part of your body **in line with the path of the saw blade**. When a KICKBACK occurs, the workpiece may be thrown towards the direction counter to the feeding with great force.

## USE PROPERLY

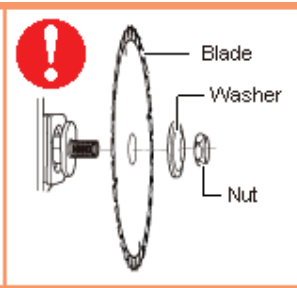
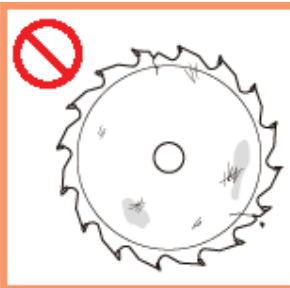

Do not use dull or damaged blades.

Do not use damaged or incorrect blade washers or nuts.

Unsharpened or improperly set blades can cause excessive friction, blade binding and KICKBACK.

## USE PROPERLY



In order to minimize the risk of coming in contact with the blade, adjust the blade height so that it is 1/8 inch higher than the top of the workpiece.



If the tool appears defective or is operating abnormally, stop the use immediately.



Never leave the saw running unattended.

Do not leave the saw until the blade comes to a complete stop.



Never alter or modify your tool.

## Quick Check List for use: YOU MUST ...

**Check!** ⇩

BEFORE use,	read the Instruction Manual.	<input type="checkbox"/>
	use safety equipment.	<input type="checkbox"/>
	not wear loose clothing or jewelry.	<input type="checkbox"/>
	contain long hair.	<input type="checkbox"/>
	disconnect the plug when preparing for use.	<input type="checkbox"/>
	check that the blade is not dull or damaged.	<input type="checkbox"/>
	check that the blade, washers and bolts are not damaged nor incorrect.	<input type="checkbox"/>
	check that the Blade Guard, splitter and anti-kickback pawls are in place.	<input type="checkbox"/>
	check that the rip fence is accurately adjusted.	<input type="checkbox"/>
	adjust the height of the blade so that it is 1/8 inch higher than the top of the workpiece.	<input type="checkbox"/>
make sure that the switch is in OFF position before connecting the plug.	<input type="checkbox"/>	
DURING use,	always hold workpiece firmly against the miter gauge or rip fence.	<input type="checkbox"/>
	keep hands away from the blade.	<input type="checkbox"/>
	not have any part of your body in line with the path of the blade.	<input type="checkbox"/>
	not rip workpiece that is twisted, warped or does not have a straightedge.	<input type="checkbox"/>
	use a push stick for small pieces of wood.	<input type="checkbox"/>
	not leave the saw until the blade comes to a complete stop.	<input type="checkbox"/>
	stop the use immediately if the tool appears defective or is operating abnormally.	<input type="checkbox"/>
OUT OF use,	disconnect the plug during inspection.	<input type="checkbox"/>
	never alter or modify the tool.	<input type="checkbox"/>

**If you have any questions or comments on this safety information, please contact the following:**

Contact Customer Service

Service Department, Hitachi Koki U.S.A.,Ltd.,  
1111 Broadway Ave., Braselton, Georgia 30517, U.S.A.  
1-866-775-9429